

KGVA

Community Development

King George County, Virginia

Typical Deck Details

Based on the 2021 Virginia Residential Code



The design details in this document apply to residential, single-level, multi span decks only. Construction cannot deviate from the details herein unless prior approval is obtained from the county. A copy of this document must be on the job site and available during each required inspection. If the guard post and rail system are not wood, the Manufactures installation guide and *ICC ESR report or other accredited listing agency report for the railing system used must be on site* for the inspection. Decks on manufactured homes must be freestanding. Attachment to a manufactured home must be by Engineer design.

King George Community Development

King George County, Virginia Typical Deck Details

CONTENTS

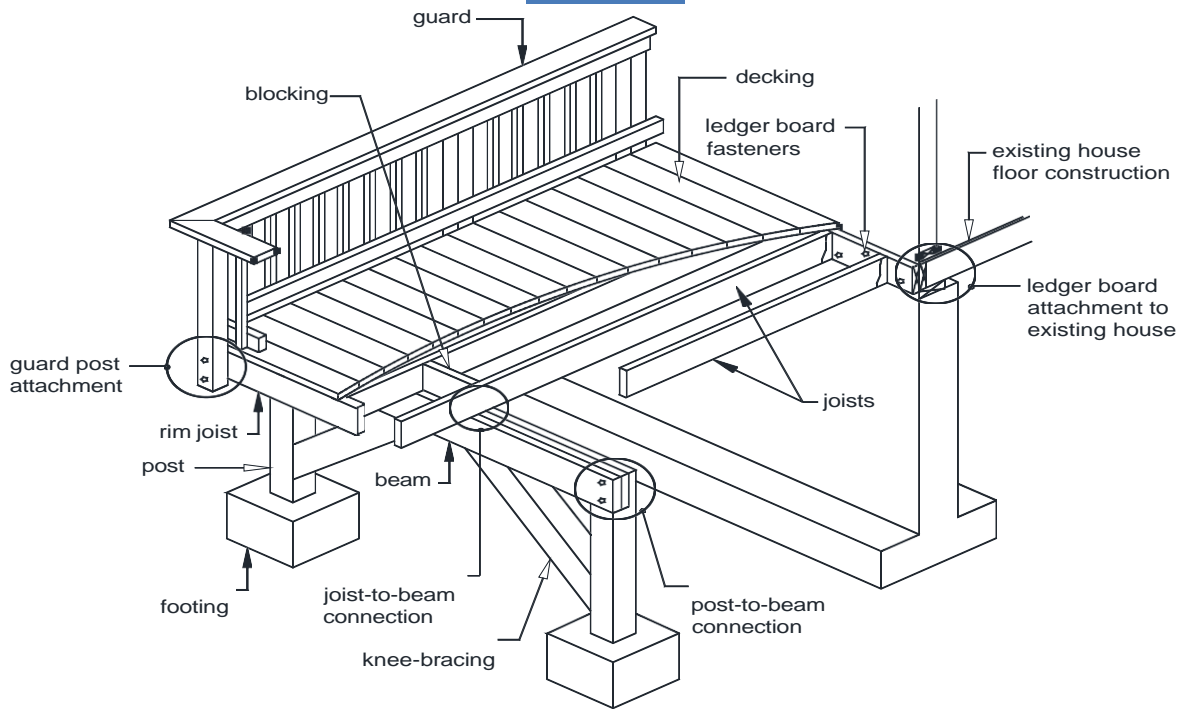

Section 1 ▪ General Notes	3	Post-to-Footing Connection	12
Design Considerations	3	Post Size & Maximum Height	13
Material Specifications	3	Beam-to-Post Connection	13
Section 2 ▪ Deck Surface	4-5	Section 6 ▪ Ledger Attachment	14-17
Decking	4	General Requirements	14
Safety Glazing	5	Ledger Board Fasteners	16
Electrical	5	Section 7 ▪ Lateral Support	18-20
Section 3 ▪ Joists	6-9	Bracing Methods	18
Joist Size/Span	6	Bracing-to-Framing Connection	20
Framing details	7	Section 8 ▪ Guards	21-22
Joist Framing at Projections	8	Guard Construction... ..	21
Joist Hangers	8	Guard Post Connections	22
Joist-to-Beam Connection	8	Section 9 ▪ Stairs	23-25
Section 4 ▪ Beams	9-11	Stair Geometry	23
Beam Size/Span... ..	10	Stair Landing	23
Beam Assembly	11	Stair Construction	23-25
Section 5 ▪ Footings & Posts	11-13	Ramps	26
Footing Size	11	Deck Ledger Certification Form	27

1 ■ General Notes

These typical deck details are provided to ensure design and construction of decks in King George County is consistent and code compliant. Prior to designing your deck, read this publication thoroughly and pay close attention to each applicable detail. Once you have selected the size of your deck, use the joist and beam span tables to determine their

size, spacing, span lengths and overhang dimensions. Use the remaining details to guide you in determining the other design elements of your deck.

If you have questions, please contact the county at **1-540-775-7111**. Information regarding permit application, zoning setbacks and inspection requirements can be found at www.king-george.va.us

DESIGN CONSIDERATIONS

1. These details are based on the prescriptive requirements of the 2021 Virginia Residential Code, industry best-practices and applicable referenced standards such as the National Design Specification for Wood Construction.
2. Framing members in these details are designed for a 40 PSF live load, 10 PSF dead load, normal loading duration, wet service conditions and deflections of $\frac{1}{360}$ for main spans and $\frac{1}{180}$ for overhangs with a 220-pound point load.
3. **The use of these details to design and construct Multi-level decks is prohibited.**
4. **The use of these details to design and construct multi-level decks is prohibited.**
5. **Deviation from these details requires approval by county staff prior to construction.**
6. **Decks constructed in accordance with these details are not approved for privacy screens, planters, built-in seating or hot tubs.**
7. Decks must be designed to ensure rain and melting ice and snow flow away from the existing house.

MATERIAL SPECIFICATIONS

1. Lumber shall be preservative-treated, southern pine, grade #2 or better.
2. Lumber in contact with the ground shall be rated as “ground-contact.” **Not all treated lumber is rated for ground contact.**
3. Concrete in footings shall have a minimum compressive strength of 3,000 PSI.
4. Nails shall be threaded, ring-shanked or annular grooved. A $\frac{1}{8}$ -inch pilot hole shall be used at toenailing locations.
5. **Carriage-bolts may be substituted** where through-bolts are specified.
6. Fasteners shall be hot-dipped galvanized, stainless steel or approved for use with preservative-treated lumber.
7. Hardware and mechanical connectors, e.g., joist hangers or post anchors, shall be stainless steel or galvanized with 1.85 ounces of zinc per square foot (G-185 coating). Look for product lines such as “Zmax,” “Triple Zinc” or “Gold Coat.”
8. Flashing at ledger board connections (see Page 14) shall be copper (with copper nails only), stainless steel, UV resistant plastic or galvanized steel with a G-185 coating.
9. Plastic composites are materials composed of bound wood and plastic fibers. Permissible as

noted in this document, plastic composites must bear a label indicating its compliance with **ASTM D 7032. Plastic composite's label and installation instructions must be available to the inspector.**

10. When using plastic composites, exercise caution as some members do not have the same capacity as their wood equivalents.
11. PVC decking and guards are permitted provided they have a valid evaluation report from an

accredited listing agency such as the International Code Council – Evaluation Service. Installation shall be in conformance with the report and the **manufacturer's instructions which must be available to the inspector.**

12. The use of other materials and products, other than those permitted herein, shall be approved by the county prior to installation.

2 ■ Deck Surface

DECKING

- Decking shall be per TABLE 1 and placed perpendicularly or at an angle up to 45 degrees to the joists.
- Wood decking shall be attached per FIGURE 1. If installed wet, place decking with no gap so after drying a 1/8-inch gap is created.
- The use of hidden fasteners and similar attachment devices must be per manufacturer installation instructions. (instructions must be available at inspection)
- Each decking member shall bear on a minimum of three joists or blocking between joists.
- Placement and attachment of plastic composites shall be per manufacturer's instructions.

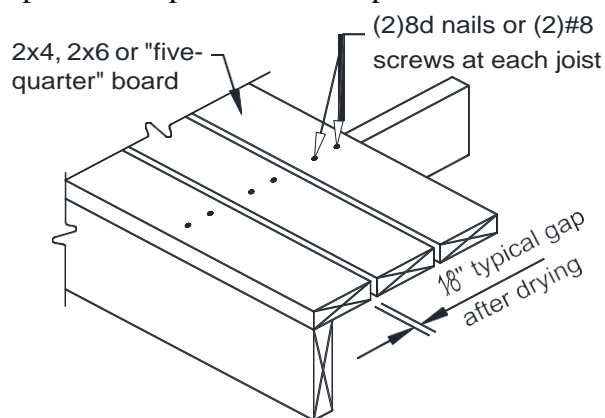

FIGURE 1: TYPICAL DECKING

TABLE 1: DECKING REQUIREMENTS AND MAXIMUM JOIST SPACING

Material Type and Nominal Size	Maximum Joist Spacing (inches)	
	Diagonal	Perpendicular
1 1/4" thick wood	12	16
2" thick wood	16	24
Plastic composites	Per ASTM D7032	Per ASTM D7032

SAFETY GLAZING

To reduce injury due to an accidental impact, safety glazing in window glass is required when the existing house wall encloses any portion of the deck surface or acts as a barrier to stairs, landings and areas at the top and bottom of the stairs. Film that meets the impact test requirements of CPSC 16 CFR 1201 is acceptable. Certification of the film is required.

Windows adjacent to a deck surface. As shown in FIGURE 2, single panes of glass meeting all the requirements listed below must be safety-glazed.

- Glass area is greater than 9 square feet,
- The bottom edge of the pane is less than 18 inches above the walking surface of the deck, and
- The top edge of the pane is greater than 36 inches above the walking surface of the deck.

In the absence of safety glazing, a horizontal rail across the window must be installed. The rail must meet the requirements of a stair handrail per Page 25.

Windows adjacent to stairways and landings. Single panes, partially or wholly located in the hatched area shown in FIGURE 2, must be safety-glazed. In the absence of safety glazing, a stair guard per Page 24 or handrail per Page 25, must be constructed to separate the window from the stairway.

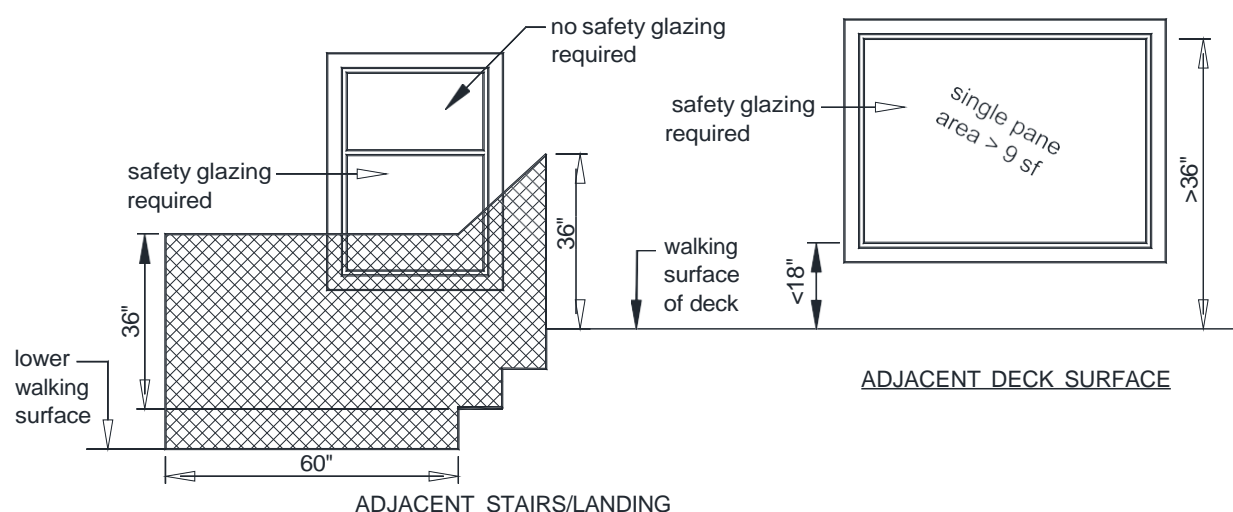

FIGURE 2: SAFETY GLAZING REQUIREMENTS

ELECTRICAL

Outlets. Decks shall have a minimum of one electrical outlet along the perimeter of the deck and within 6.5 feet of the floor.

Stair lighting. Each stairway section shall have a light source that illuminates all stairs and landings. Lights shall be operated from interior switches, motion detectors or timed switches. Low voltage lighting that casts adequate light on the stairs is permissible.

3 ■ Joists

- Joists are repetitively placed framing members spaced at 12, 16 or 24 inches on center which are supported at each end by a beam or ledger board.
- Single span decks are framed with joists that have one span between supports (not including overhang) as shown in FIGURES 3 and 4. Multi-span decks have joists with more than one span which bear on multiple beam as shown in FIGURES 5 and 6.
- At the house connection, joists bear on the attached ledger board. Joists on a free-standing deck do not connect to the house; instead bearing is provided by an additional beam located at or near the house wall as shown in FIGURE 7.

JOIST SIZE

- Joist span length is measured from the ledger board to the centerline of the supporting beam or between the centerlines of the supporting beams at each end.
- Joists are permitted to overhang past a dropped beam; joist span length does not include overhangs.
- The joists' design is based on spacing, size and span length. Use TABLE 2 to determine joist size and the corresponding maximum allowable overhang. **Note: the overhang dimension shall never exceed one-fourth of the actual joist span.**
- Provide full-depth 2x blocking between overhanging joists above beam locations. Exception: blocking may be omitted if the overhang is less than or equal to 2 feet.
- Where blocking between joists is required, attach blocking using joist hangers at each end or by toenailing blocking to joists at each end, top and bottom with 10d nails.
- Attach a continuous rim joist or blocking at the joist ends as shown in FIGURES 3, 5 and 7. Attach a rim joist to the end of each joist with (3)10d nails or (3) #10 by 3-inch wood screws.
- When choosing 2x6 joists, the corresponding ledger board must be a 2x8 minimum. See Page 14 for more information.
- Guards cannot be attached to decks framed with 2x6 joists. See Page 21 for more information.

TABLE 2: MAXIMUM JOIST SPAN LENGTH for Southern Pine

Joist Spacing (inches on center)	Joist Size	Joist With No Cantilever	Maximum Cantilever
12	2x6	9'-11"	1'3"
	2x8	13'-1"	2'1"
	2x10	16'-2"	3'4"
	2x12	18'-0"	4'6"
16	2x6	9'-0"	1'4"
	2x8	11'-10"	2'3"
	2x10	14'-0"	3'6"
	2x12	16'-6"	4'2"
24	2x6	7'-7"	1'6"
	2x8	9'-8"	2'5"
	2x10	11'-5"	2'10"
	2x12	13'-6"	3'4"

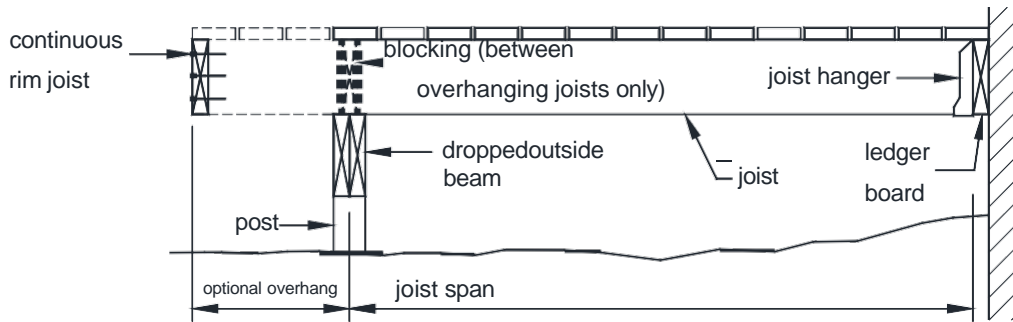

FIGURE 3: SINGLE SPAN DECK - JOISTS ATTACHED AT HOUSE WITH DROPPED BEAM

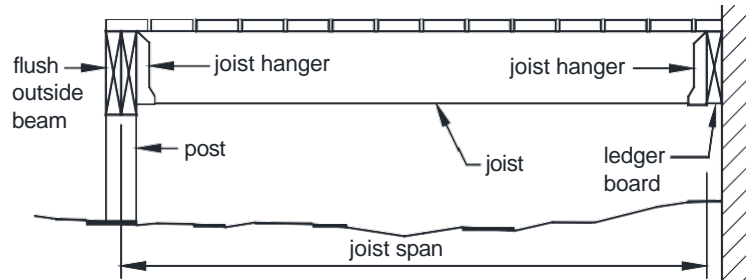
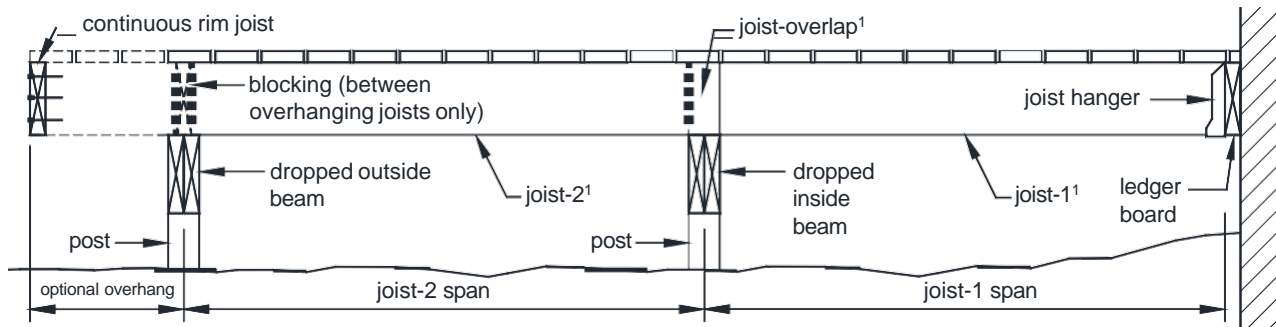

FIGURE 4: SINGLE SPAN DECK - JOISTS ATTACHED AT HOUSE WITH FLUSH BEAM



¹ One continuous joist is permitted to span over the top of the inside dropped beam with no overlap.

FIGURE 5: MULTI-SPAN DECK - JOISTS WITH DROPPED BEAMS

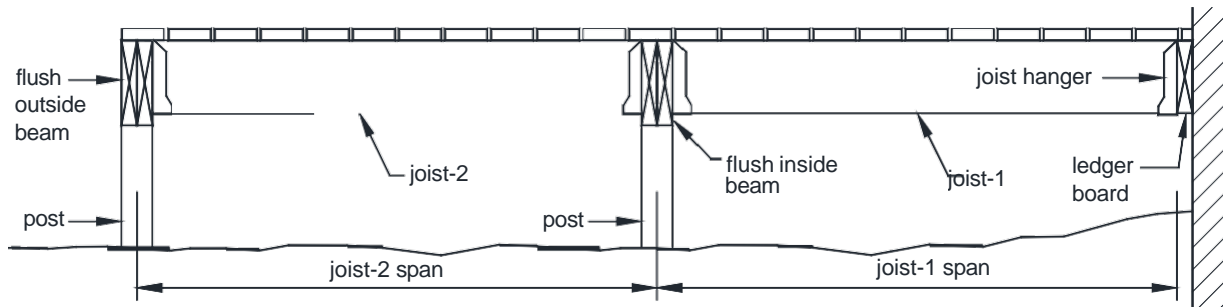
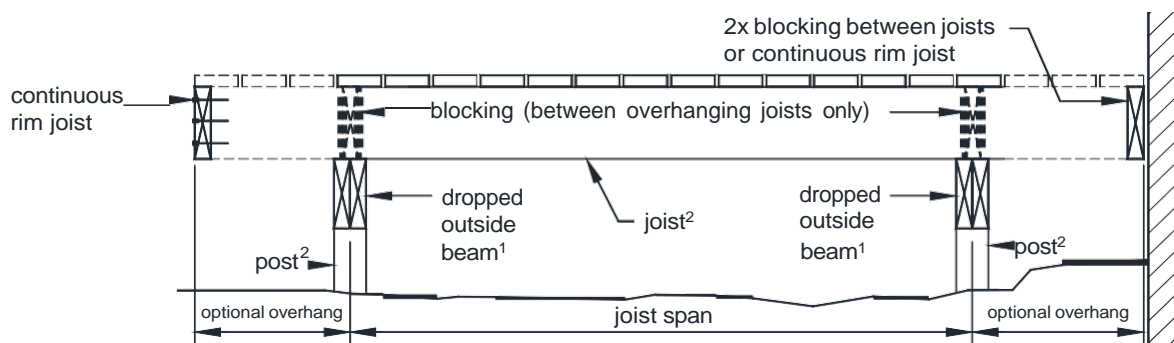

FIGURE 6: MULTI-SPAN DECK - JOISTS WITH FLUSH BEAMS



¹ Flush beams are permitted with freestanding decks when joists do not overhang.

² Align joists to be located at post locations in order to accommodate lateral bracing per FIGURE 30.

FIGURE 7: JOISTS WITH FREESTANDING DECKS

FRAMING AT PROJECTIONS

Additional framing and ledger board fasteners per Section 6 on Page 15 are required at projections such as chimneys or bay windows as shown in FIGURE 8. Each ply of the header shall be equal to the deck joist size. Joist hangers shall meet the requirements below.

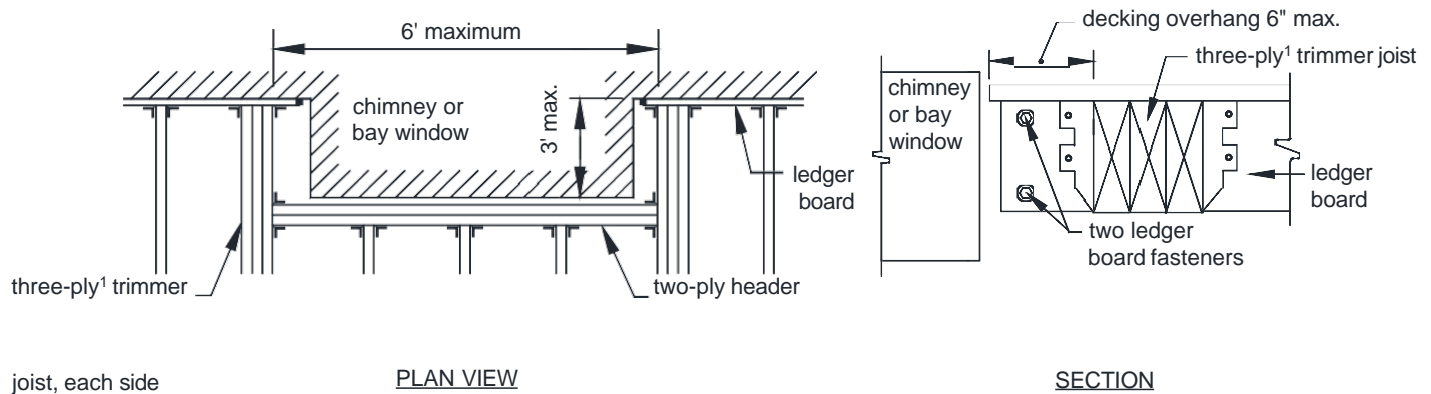

FIGURE 8: FRAMING AT CHIMNEY OR BAY WINDOW

JOIST HANGERS

- Joist hanger depth, d , as shown in FIGURE 9, shall be greater than or equal to 60 percent of the joist depth.
- The manufactured width of the joist hanger shall accommodate the number of plies being carried.
- Do not bend hanger flanges to accommodate field conditions.
- Joist hangers shall be fastened to the ledger board or flush beam using its manufacturer's recommended screws or nails. All other fasteners are permitted to be nailed.
- Use joist hangers with inside flanges when clearances to the edge of the beam or ledger board dictate.
- **Clip angles or brackets used to support framing members in lieu of joist hangers are prohibited** unless tested and listed for that use. Provide specs at inspection if used.

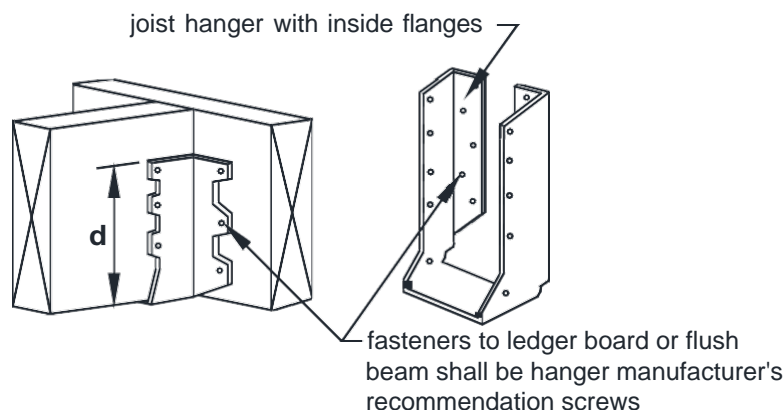

FIGURE 9: JOIST HANGERS

JOIST-TO-BEAM CONNECTION

- Each joist shall be attached to the beam in accordance with FIGURE 10.
- Mechanical connectors or hurricane clips shall have a minimum capacity of 100 pounds in both uplift and lateral directions. Installation shall be per manufacturer's instructions.
- As shown in FIGURE 10, multi-span joists are permitted to span continuously over a dropped interior

beam with one mechanical connector or overlap with a mechanical connector at each joist.

- 3-8d toe nail connections

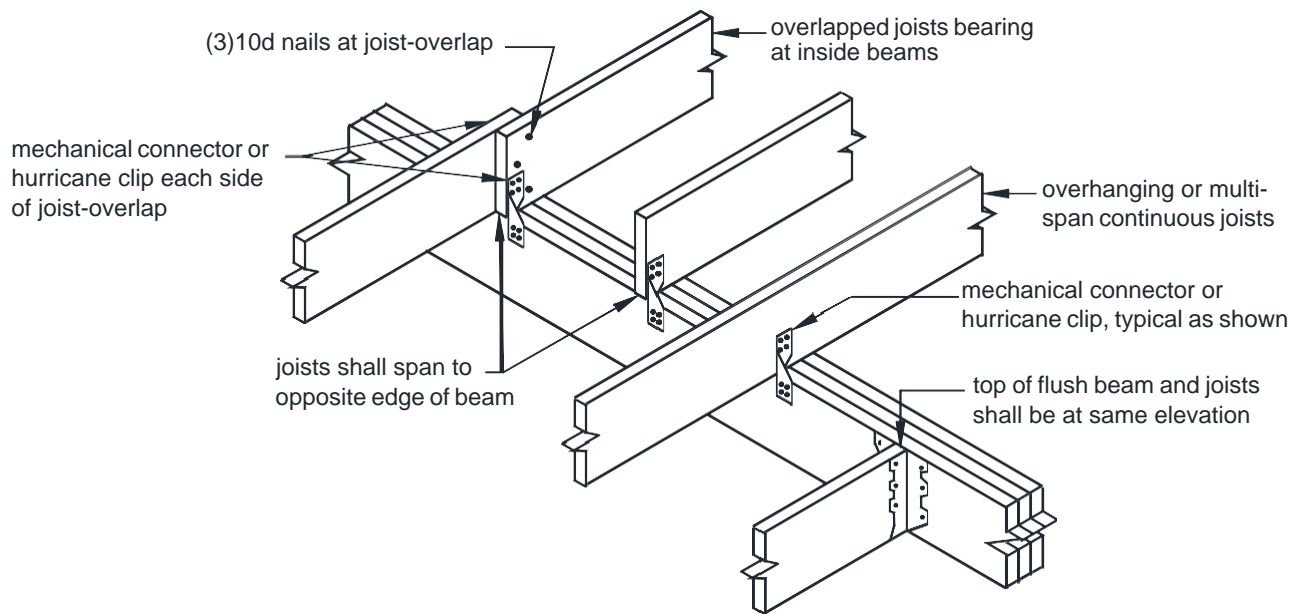

FIGURE 10: JOIST-TO-BEAM CONNECTION

4 ■ Beams

- Beams are assembled, multi-ply framing members which span between supporting posts. Multi-span decks have more than one beam; spacing between beams is dependent on the allowable span lengths of the supported joists.
- Inside beams have joists bearing from each side. Outside beams have joists, with or without an overhang, bearing from one side.
- Dropped beams have joists bearing above; flush beams have joists with hangers bearing on its sides; see FIGURES 3 through 7 and FIGURE 11.
- Multi-span decks are permitted to mix flush and dropped beams.

BEAM SIZE

- Beam size is based on its influence width and longest span length per TABLE 3. Beam influence width, as shown in FIGURE 12, is based on supported joists' span lengths and overhang dimensions.
- Beam span length, as shown in FIGURE 11, is measured between the centerlines of two adjacent posts and does not include the beam overhangs.
- Beams may overhang past the center of the post up to one-fourth of the actual beam span.
- Flush beams shall have a depth greater than or equal to the deepest joist.

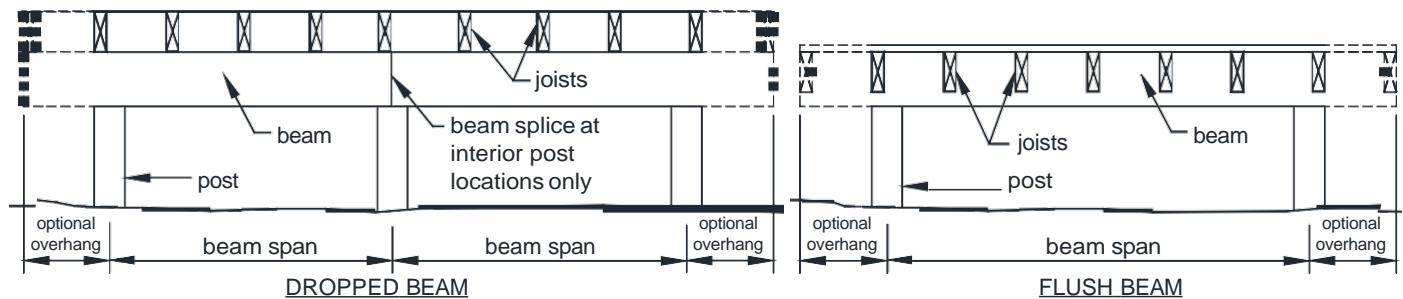

FIGURE 11: BEAM TYPES

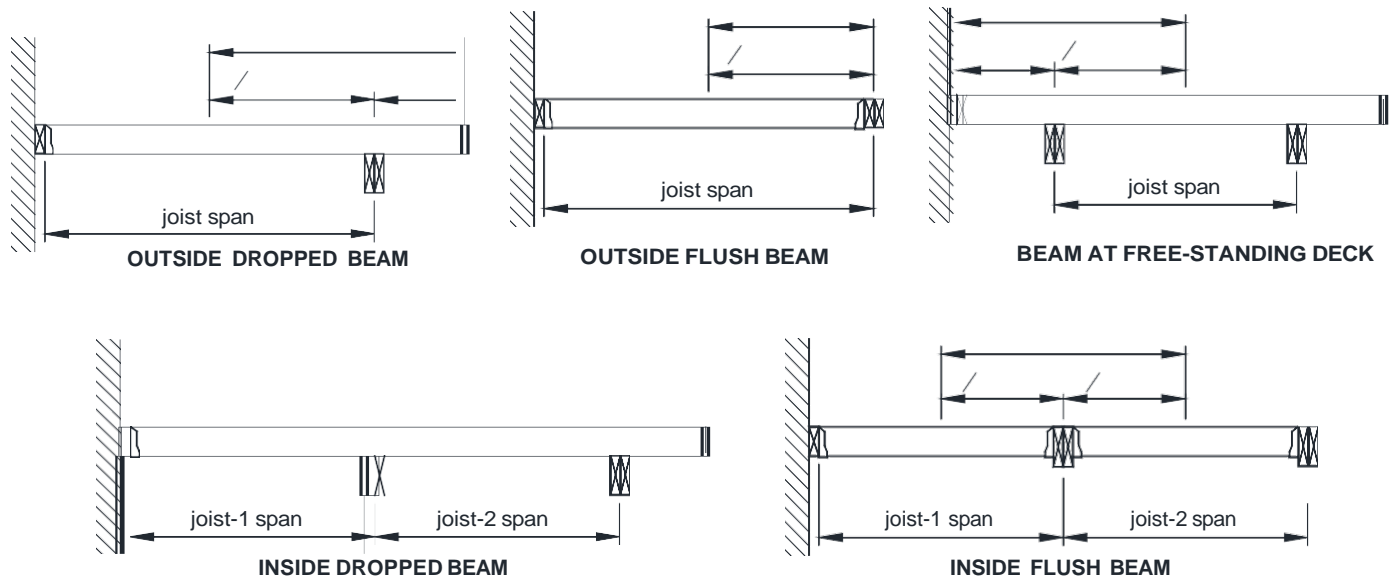

TABLE 3: Deck Beam Span Lengths
All spans shown below are southern pine

size	Deck Joist Span Less Than Or Equal To:						
	6	8	10	12	14	16	18
1-2x6	4-7	4-0	3-7	3-3	3-0	2-10	2-8
1-2x8	5-11	5-1	4-7	4-2	3-10	3-7	3-5
1-2x10	7-0	6-0	5-5	4-11	4-7	4-3	4-0
1-2x12	8-3	7-1	6-4	5-10	5-5	5-0	4-9
2-2x6	6-11	5-11	5-4	4-10	4-6	4-3	4-0
2-2x8	8-9	7-7	6-9	6-2	5-9	5-4	5
2-2x10	10-4	9-0	8-0	7-4	6-9	6-4	6-0
2-2x12	12-2	10-7	9-5	8-7	8-0	7-5	7-0
3-2x6	8-6	7-5	6-8	6-1	5-8	5-3	4-11
3-2x8	10-11	9-6	8-6	7-9	7-2	6-8	6-4
3-2x10	13	11-2	10-0	9-2	8-6	7-11	7-6
3-2x12	15-3	13-3	11-10	10-9	10-0	9-4	8-10

¹ Design conditions which fall within the shaded cells are prohibited.

BEAM ASSEMBLY

- The plies of the beam shall be fastened in accordance with FIGURE 13.
- The distance from the centerline of the fastener to the top or bottom edge of the beam shall be ½-inch minimum.
- The distance from the centerline of the fastener to the ends of the beam shall be 1-inch minimum.
- Beam plies are permitted to have splices. However, splices shall be located at post connections as shown in FIGURE 11.

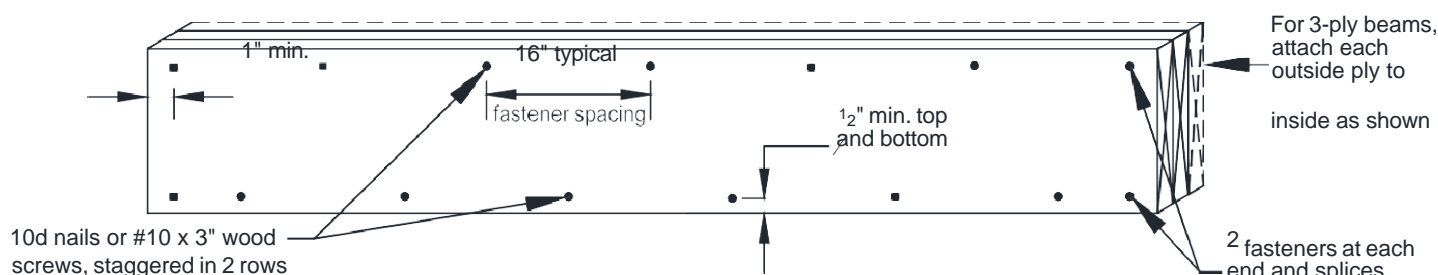

FIGURE 13: BEAMPLY FASTENING

5 ■ Footings & Posts

FOOTING SIZE

Footing size is found by using **TABLE 4** to obtain the footing type based on the tributary area.

- Footing sizes shall be consistent for each beam and designed for its maximum span.
- Footings shall bear on solid ground 18 inches below grade; footings shall be deeper if solid ground is not found. Bearing conditions must be verified by county inspectors prior to placement of concrete.
- When the **edge of a deck footing is closer than 5 feet to an existing exterior house wall**, the footing must bear at the same elevation as the existing house footings as shown in **FIGURE 14**.
- Do not construct footings over utility lines, service pipe, or septic tanks. Call Miss Utility at 811 before you dig.

TABLE 4: MINIMUM FOOTING SIZE FOR DECKS

Tributary Area (sq. ft.)	Side of a square footing (inches)	Diameter of a round footing (inches)	Thickness (inches)
5	7	8	6
20	9	9	6
40	12	14	6
60	15	17	6
80	17	19	6
100	19	21	6
120	21	23	7
140	22	25	8

160	24	27	9
-----	----	----	---

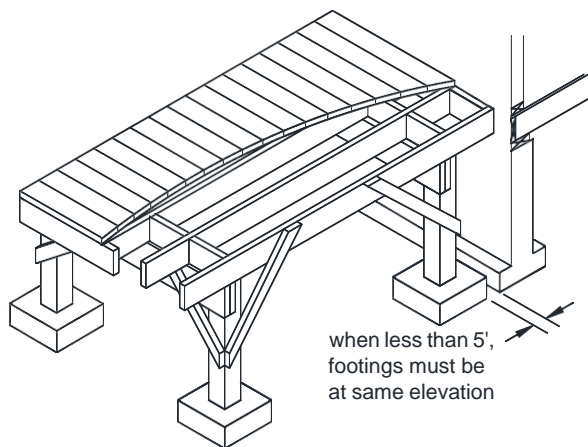
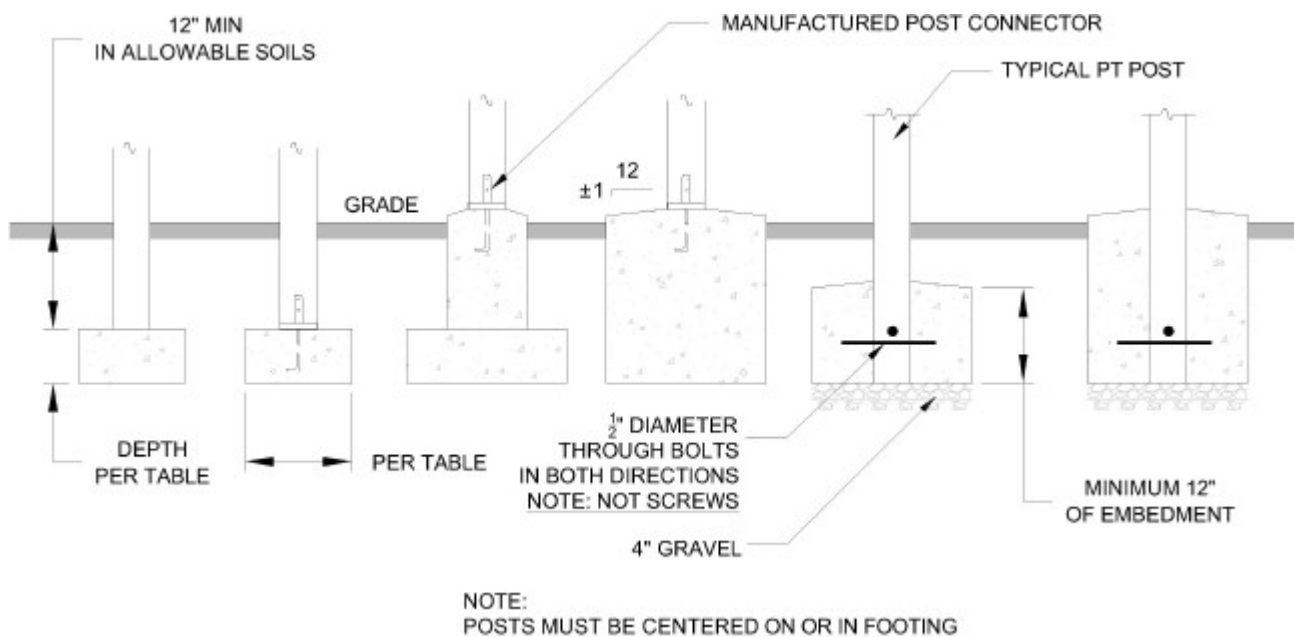

FIGURE 14: FOOTINGS ADJACENT EXISTING HOUSE

POST-TO-FOOTING CONNECTION

- Post attachment requirements shall be in accordance with **FIGURE 15**.
- A-B Shall have an approved post anchor installed per manufactures instructions.
- Post anchors shall have a 1-inch minimum base.
- Posts shall be centered on the footing.

FIGURE 15: FOOTINGS



***NOTE: Min. 18" footing depth.**

POST SIZE & MAXIMUM HEIGHT

TABLE 5: MAXIMUM POST HEIGHT

Post Size	Tributary Area (ft ²)							
	20	40	60	80	100	120	140	160
4x4	14-0	13-8	11-0	9-5	8-4	7-5	6-9	6-2
4x6	14-0	14-0	13-11	12-0	10-8	9-8	8-10	8-2
6x6	14-0	14-0	14-0	14-0	14-0	14-0	14-0	14-0
8x8	14-0	14-0	14-0	14-0	14-0	14-0	14-0	14-0

- Post height is measured from the top of the footing to the underside of the beam.
- Cut ends of posts shall be field treated with a wood preservative containing copper naphthenate which can be found in the paint department of most hardware or home center stores.

BEAM-TO-POST CONNECTION

- Beams shall be attached to 6x6 posts using one of the methods shown in **FIGURE 16** or **17**. Beams shall be attached to 4x4 posts using the method shown in **FIGURE 17**.
- 4x4 posts are prohibited from supporting three-ply beams.
- Beams shall not be attached to the sides of an unnotched post as shown in **FIGURE 18**.
- Pre-manufactured post caps shall be specifically designed for two- or three-ply beams and the post size used. Attachment shall be per manufacturer's instructions.

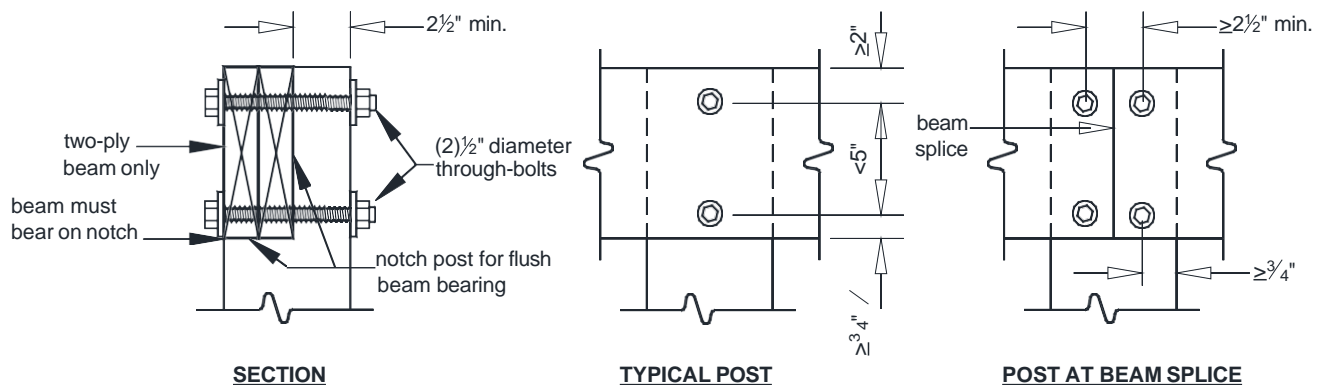

FIGURE 16: NOTCHED 6x6 POST-TO-BEAM CONNECTION

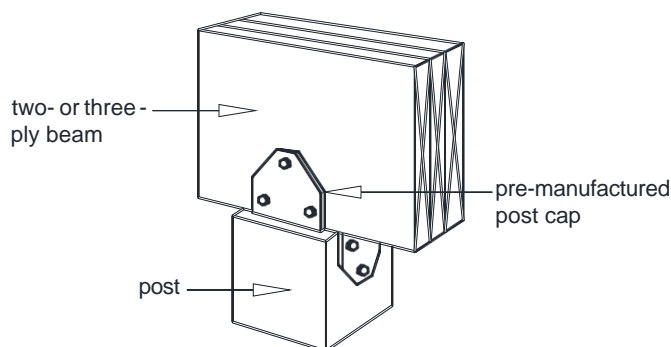

FIGURE 17: POST CAP CONNECTION

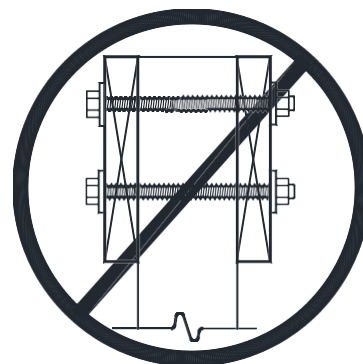

FIGURE 18: PROHIBITED CONNECTION

6 ■ Ledger Board Attachment

GENERAL REQUIREMENTS

- Ledger boards shall be attached to the existing house in accordance with the requirements herein. Compliance is critical to ensure the safety and structural stability of your deck.
- Ledger board depth shall be greater than or equal to the depth of the deck joists, but not less than a 2x8.
- The ledger board shall be attached in accordance with one of the conditions shown in **FIGURES 20 through 22.**
- The existing band board shall be capable of supporting the deck. If this cannot be verified or existing conditions differ from the details herein, then a free-standing deck or an engineered design is required.
- The top of the ledger board and top of the deck joists shall be at the same elevation.

Wood I-joists. Many homes are constructed with wood I-joists, as shown in **FIGURE 19**. Rather than utilize a 2x band board, these systems are often constructed with a minimum 1-inch thick engineered wood product (EWP) band board capable of supporting a deck. **If a minimum 1-inch EWP or 2x band board is not present, then a free-standing deck or an engineered design is required.**



FIGURE 19: WOOD I-JOISTS

Flashing. Flashing shall be installed in accordance with the following requirements. See Page 3 for flashing material specifications.

- The exterior finish, i.e., house siding, must be removed prior to the installation of the ledger board.
- Continuous flashing, as shown in **FIGURE 20**, is required at the ledger board when attached to wood- framed construction.

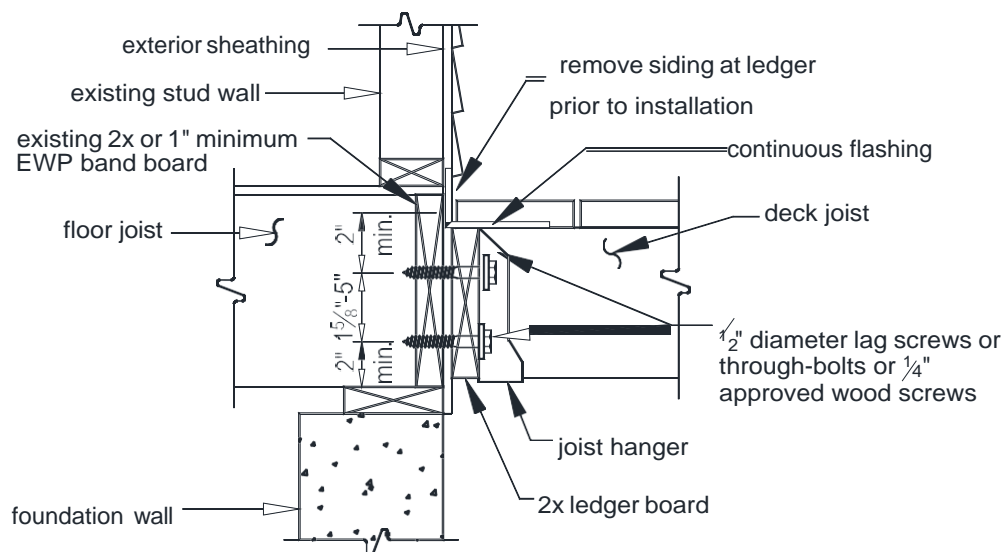

FIGURE 20: LEDGER BOARD-TO-BAND BOARD ATTACHMENT

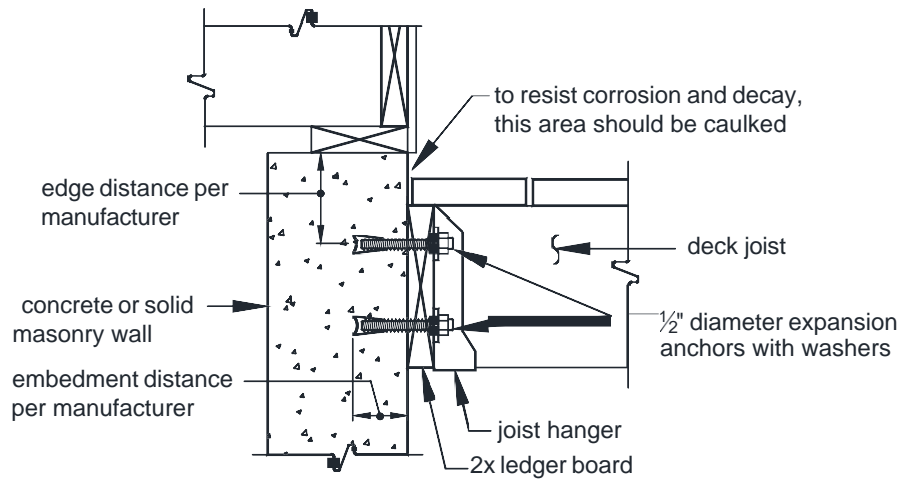

FIGURE 21: LEDGER BOARD-TO-SOLID FOUNDATION ATTACHMENT

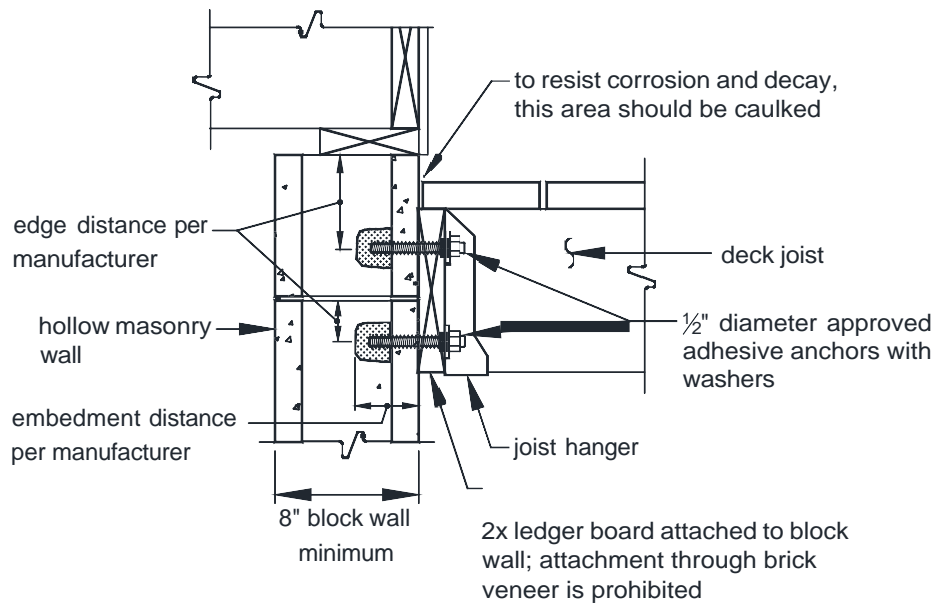

FIGURE 22: LEDGER BOARD-TO-HOLLOW FOUNDATION ATTACHMENT

Prohibited ledger attachments. The ledger board attachment conditions shown below are prohibited. In such cases, a free-standing deck or engineering design is required.

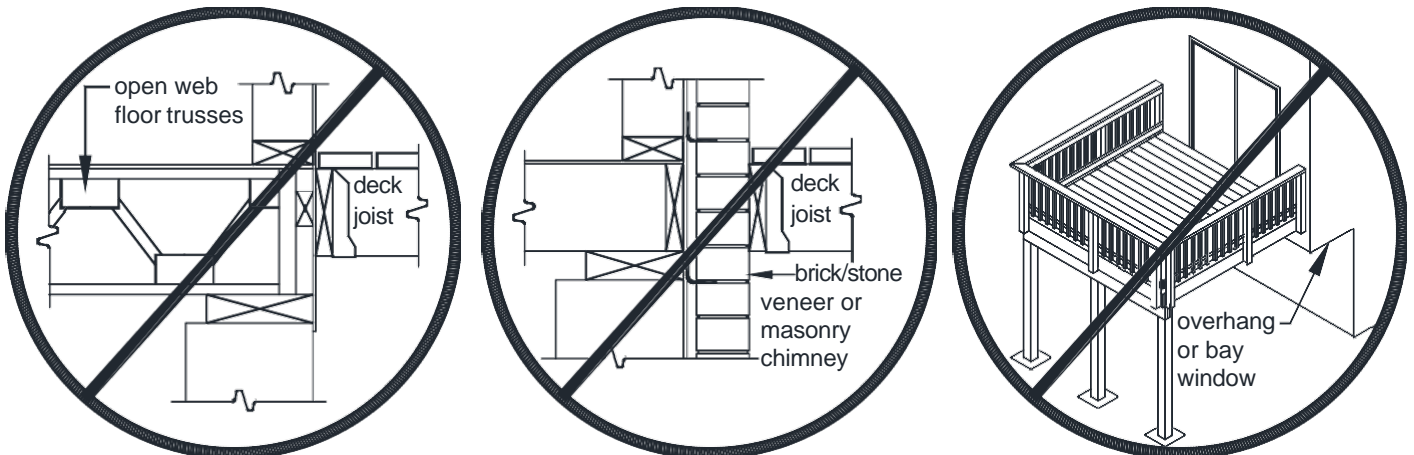

FIGURE 23: PROHIBITED LEDGER ATTACHMENTS

LEDGER BOARD FASTENERS

General requirements. Ledger board fasteners shall be installed in accordance with this section. Placement and spacing shall be in accordance with **FIGURE 24** and **TABLE 6**. Only those fastener types noted herein are approved for use; lead anchors are prohibited. Adequacy of connections will be verified by county inspectors.

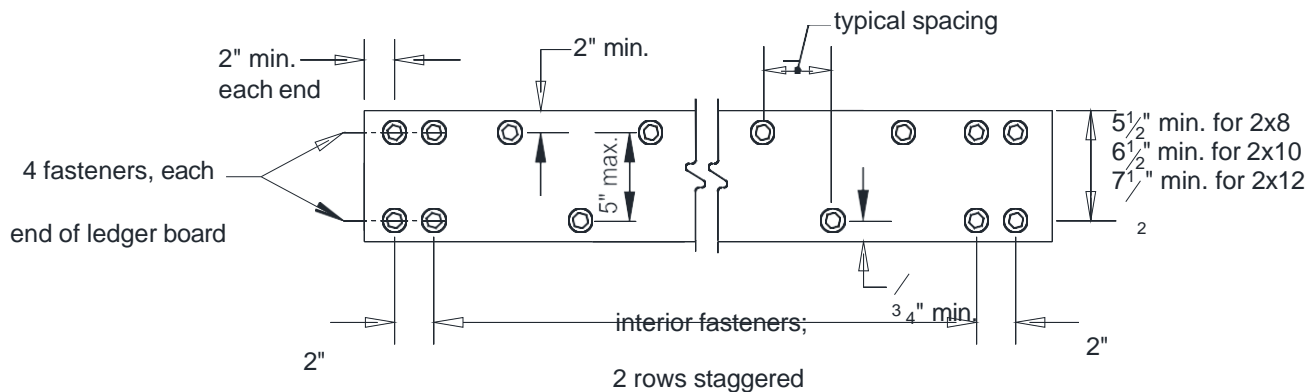

FIGURE 24: LEDGERBOARD FASTENERS SPACING AND CLEARANCES

TABLE 6: LEDGER BOARD FASTENER SPACING, INCHES ON CENTER

Fastener	Band Board	Joist Span (feet), less than or equal to						
		6	8	10	12	14	16	18
Lag Screws	EWP ¹	24	18	14	12	10	9	8
	2x Lumber	30	23	18	15	13	11	10
Through-Bolts	EWP ¹	24	18	14	12	10	9	8
	2x Lumber	36	36	34	29	24	21	19
SDS, LedgerLok Wood Screws	EWP ¹	12	9	7	6	5	4	4
	2x Lumber	13	10	8	6	5	5	4
SDWS, WS-EXT, WSWH-EXT Wood Screws ²	EWP ¹	14	10	8	7	6	5	5
	2x Lumber	22	16	13	11	9	8	7
Expansion Anchors	—	36	36	34	29	24	21	19
Adhesive Anchors	—	32	32	32	24	24	16	16

¹EWP = 1-inch minimum manufactured engineered wood product; see Page 14 for more information

²Wood screws shall be permitted to be spaced in accordance with it current corresponding evaluation report if less restrictive than the values in TABLE 6.

Through-bolts. Through-bolts shall have a minimum ½-inch diameter. Pilot holes for through-bolts shall be $\frac{17}{32}$ to $\frac{9}{16}$ inches in diameter. Through-bolts must be equipped with washers at the bolt-head and nut. Bolts should be tightened six to 12 months after construction due to drying and wood shrinkage.

Expansion anchors. Expansion anchors shall be used only when attaching a ledger board to a concrete or solid masonry wall as shown in FIGURE 21. The bolt or threaded rod of expansion anchors shall have a ½-inch diameter minimum; in some cases, this may require a ⅝-inch anchor size. Expansion anchors must be installed per manufacturer’s instructions and shall be equipped with washers.

Adhesive anchors. The adhesive anchors listed in with a minimum ½-inch diameter threaded rod shall be used when attaching to concrete or solid or hollow masonry as shown in FIGURE 22. Anchors shall be installed per manufacturer’s instructions and shall be equipped with washers. Adhesive cartridges must be remain on the jobsite for inspector verification.

**TABLE 7: APPROVED
ADHESIVE ANCHOR**

Manufacturer	Product
Red Head	Epcon A7
Hilti	HY-70

Lag screws. Lag screws shall be hot-dipped galvanized or stainless steel with a ½-inch minimum diameter. Length and shank requirements shall be in accordance with **FIGURE 25**. Lag screws shall be equipped with washers and installed in the sequence below.

1. Drill a ½-inch diameter hole in the ledger board and a 5/16-inch diameter pilot-hole into the solid connection material of the existing house.
2. Insert the lag screw through the ledger board and into the pilot hole by turning. Do not drive with a hammer. Use soap or a wood-compatible lubricant as required to facilitate tightening.
3. Tighten each lag screw snugly, but do not over tighten so as to cause wood damage.

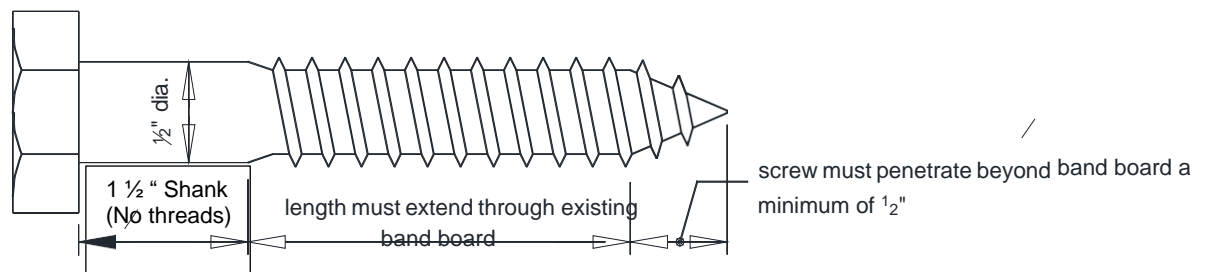

FIGURE 25: LAG SCREW

Wood screws. The wood screws listed in

TABLE 8 with a ¼-inch diameter may be used to attach to wood-framed construction. Wood screws shall have a sufficient length to fully penetrate the existing house band board. Installation shall be in conformance with the manufacturer’s instructions.

TABLE 8: APPROVED WOOD SCREWS

Manufacturer	Product
Fasten Master	LedgerLOK
Simpson Strong-Tie	SDS Strong-Drive Screws
Simpson Strong-Tie	SDWS Strong-Drive Screws
USP	WS-EXT
USP	WSWH-EXT

7 ■ Lateral Support

BRACING METHODS

All decks are required to be designed to resist lateral load caused by human activity and environmental forces. Use **TABLE 9** to determine the applicable methods based on post height and deck type as defined in Section 3.

TABLE 9: LATERAL SUPPORT REQUIREMENTS

Post Height (feet) Less than or equal to:	Single Span Decks	Multi-Span Decks	Free-Standing Decks
11	Method 1 or Method 2	Method 2	Method 2 and Method 3
14	Method 1 and 2	Method 1 and 2	Method 1, 2, and 3

Type	Capacity	Amount
Hold-down Tension Device	1500 pound capacity	2 per deck
LTS19	750 pound capacity	4 per deck
DTT1	750 pound capacity	4 per deck

FIGURE 26: TENSION-TIES

¹ Method 2 may be omitted from the beam closest to the existing house wall if Method 1 is utilized at the house connection.

Method-1, Tension-ties (four total):

- 1 hold-down tension device shall installed in not less than two locations per deck, within 24 inches of each end of the deck.
- Tension-ties shall be attached to the joists and exterior wall per the manufacturer's instructions with specified fasteners as shown in **FIGURE 28**. Fasteners shall penetrate a minimum of 3 inches into the sill plate or top plate of a wood framed wall.



LTS19 DTT1

FIGURE 26: TENSION-TIES

- Approved tension-ties include: LTS19 from USP or DTT1 from Simpson Strong-Tie; see **FIGURE 26**. The minimum capacity of each tension-tie shall be 750 pounds.
- Where attaching to a concrete or solid masonry wall, fasteners are permitted to be substituted with expansion anchors or adhesive anchors with a threaded rod as recommended by the tension-tie manufacturer. The withdrawal capacity of the anchors shall be a minimum of 750 pounds. The anchor

shall be installed per its manufacturer recommendations.

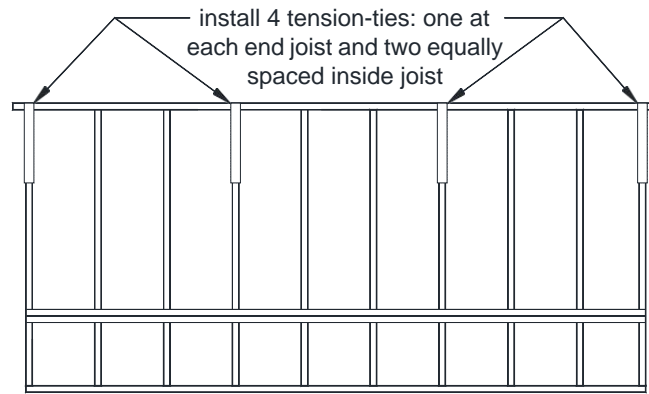
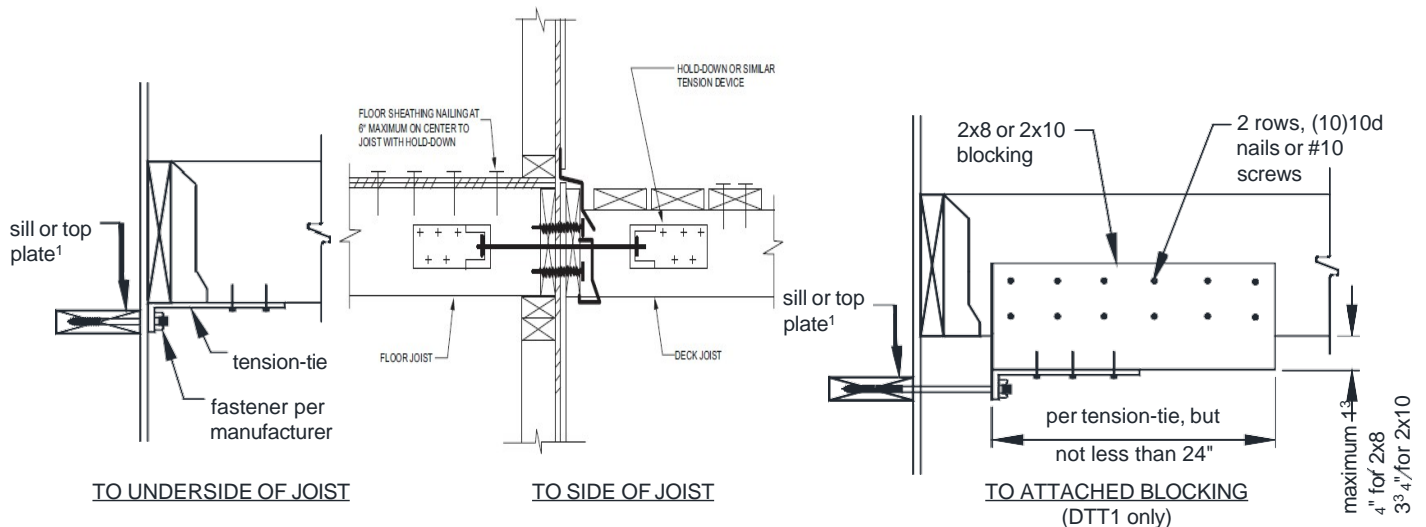

FIGURE 27: METHOD 1 - TENSION TIE LOCATION



¹ Tension-ties may be anchored to concrete or solid masonry walls with expansion or adhesive anchors as permitted on Page 18.

FIGURE 28: METHOD 1 - TENSION-TIE CONNECTION

Method-2, Knee-bracing at beam:

- Knee-bracing shall be comprised of 2x or 6x6 members.
- Decks shall have 2x knee-bracing installed at each post-beam location or 6x6 knee-bracing at end posts and both sides of every other interior post in accordance with **FIGURE 29**.
- Connections of knee-bracing shall be in accordance with **FIGURE 31** or **32**.

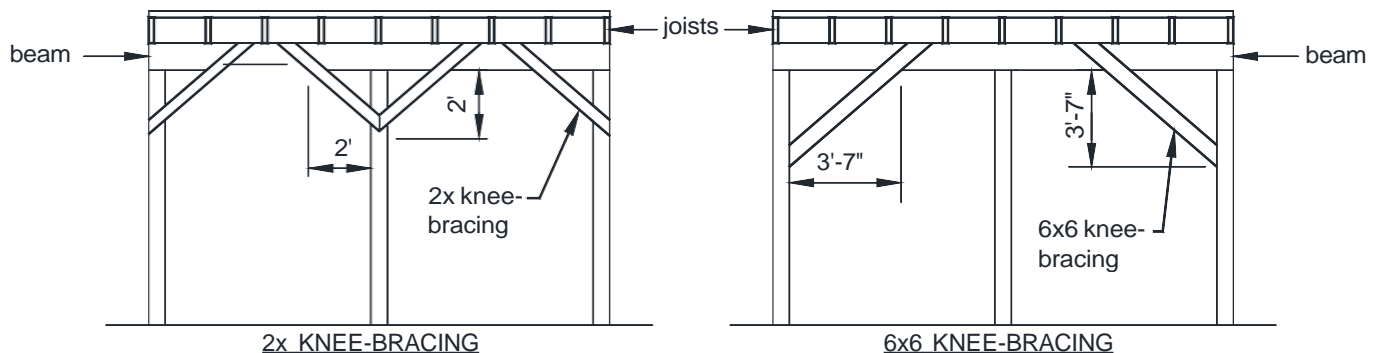

FIGURE 29: METHOD 2 - KNEE-BRACING AT BEAM-POST LOCATIONS

Method-3, Knee-bracing at joists-post locations (free-standing decks only):

- Knee-bracing shall be comprised of 2x or 6x6 members.
- Knee-bracing shall be installed at each post-joist location in accordance with **FIGURE 30**.
- Connections of knee-bracing shall be in accordance with **FIGURE 31** or **32**.

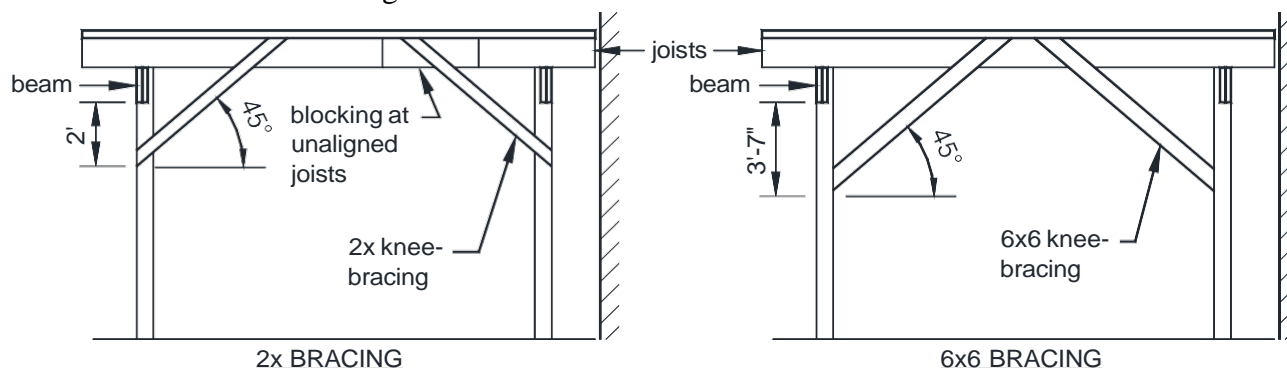
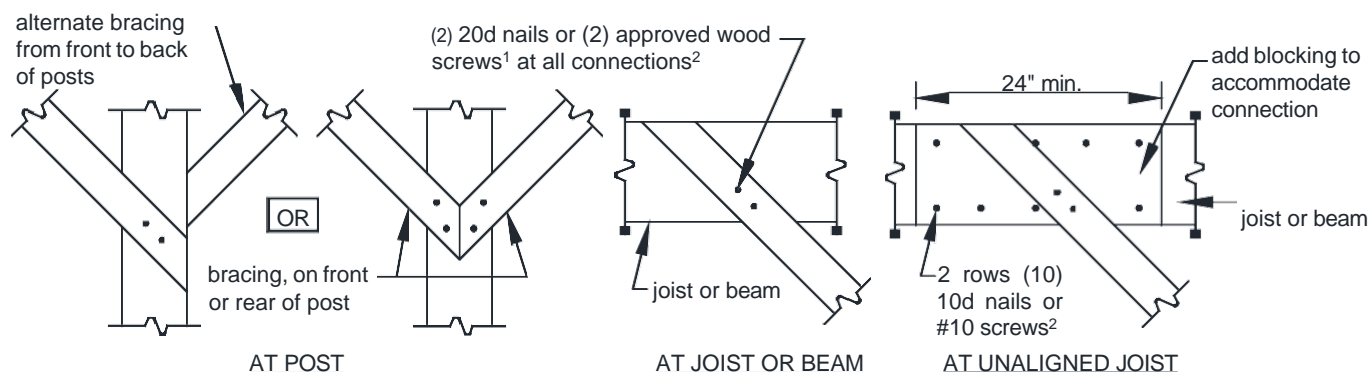

FIGURE 30: METHOD 3 - KNEE-BRACING AT JOIST-POST LOCATIONS

BRACING-TO-FRAMING CONNECTIONS



¹ Approved wood screws are listed in TABLE 8.

² Nails shall have a distance of $\frac{3}{8}$ inches to all edges and $\frac{7}{8}$ inches to ends of the bracing member.

FIGURE 31: TYPICAL CONNECTIONS OF 2x KNEE-BRACING

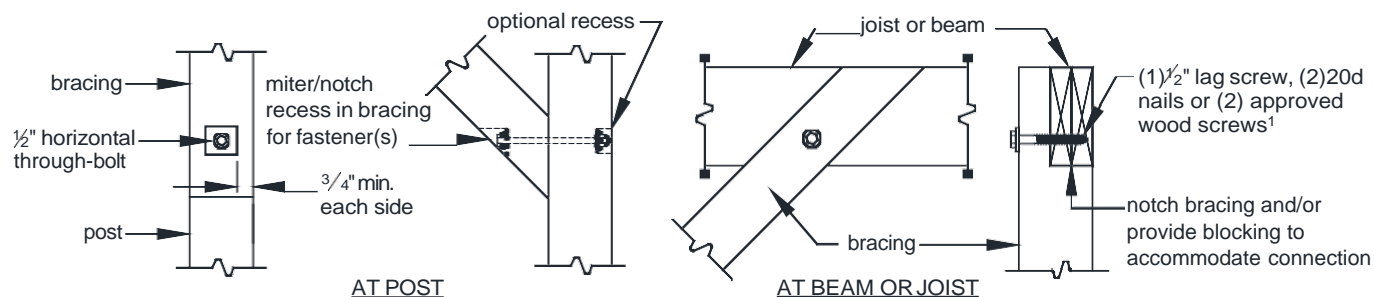

¹ Approved wood screws are listed in TABLE 8.

FIGURE 32: TYPICAL CONNECTIONS OF 6x6 KNEE-BRACING

8 ■ Guards

GUARD CONSTRUCTION

A guard is required when a deck is greater than 30 inches above grade at a point 36 inches from the edge of the deck, as shown in **FIGURE 33**. Guards shall be constructed in accordance with the requirements herein; deviations are prohibited. Guards which are not required, but are nevertheless provided, must also comply with these requirements.

Plastic composites. Plastic composites of equal dimension and complying with the criteria noted on Page 3 may be substituted for the guard cap and infill elements shown in **FIGURE 34** provided the manufacturer's performance criteria specifically permit such use.

Guard systems. Guard systems with a valid evaluation report from an accredited listing agency are permitted as referenced on Page 3. Pre-fabricated systems without an evaluation report will require a plan review during the permit application process.

Openings. Guards shall be constructed to restrict the passage of a 4-inch diameter sphere through any opening. Wet lumber shall be spaced such that when shrinkage occurs, a compliant opening is maintained.

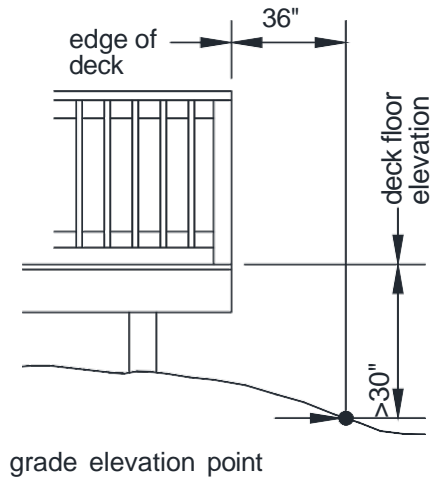

FIGURE 33: WHEN A GUARD IS REQUIRED

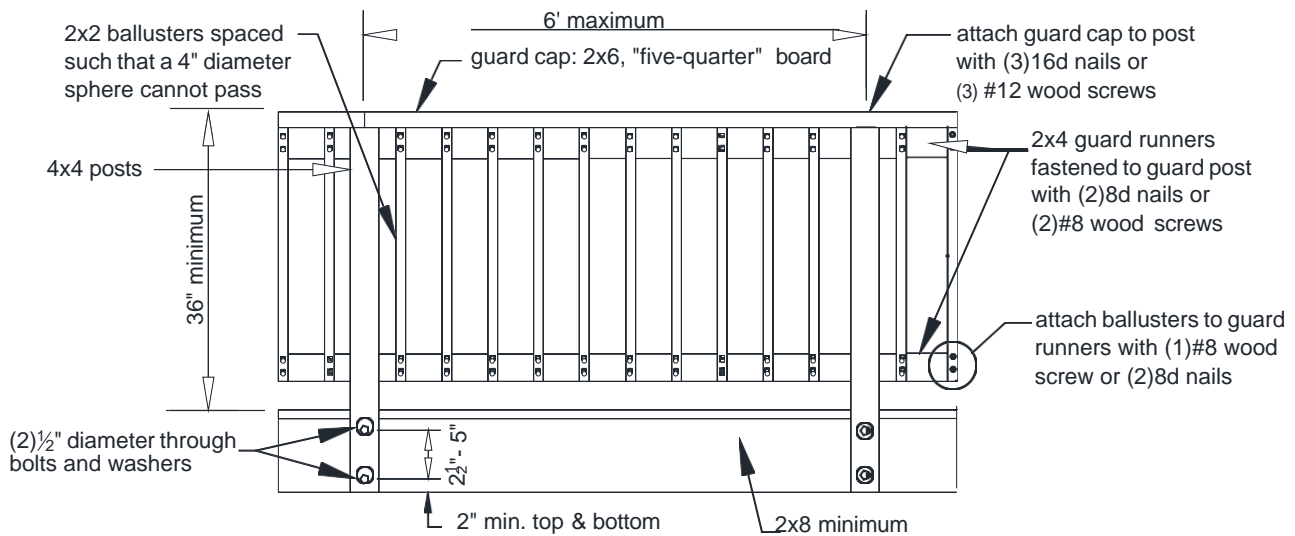

FIGURE 34: GUARD CONSTRUCTION

GUARD POST CONNECTION

Guard posts shall be attached to the deck structure in accordance with the requirements below in order to ensure resistance to imposed loads.

- Notching guard posts, as shown in **FIGURE 35**, is prohibited.
- 2x4 guard runners may be face nailed as shown in the detail or inset between posts if attached with approved brackets or provided engineered design.
- Tested and listed post attachment screw systems may be used in lieu of ½" through bolts. Provide approval report and installation guide at inspection.
- Hold-down anchors, as shown in **FIGURES 37** and **38**, shall be used to attach the guard post to the end joist and rim joist, respectively.
- Hold-down anchors shall have a minimum capacity of 1,800 pounds.
- Guards may be attached to either side of the rim joist or end joist.

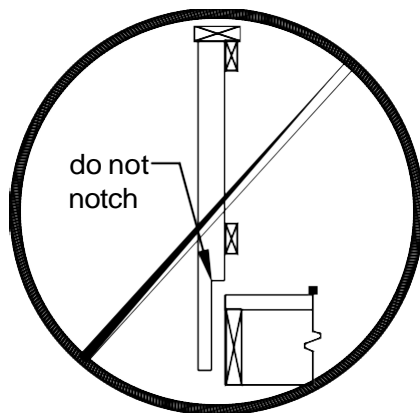

FIGURE 35: POST NOTCHES PROHIBITED

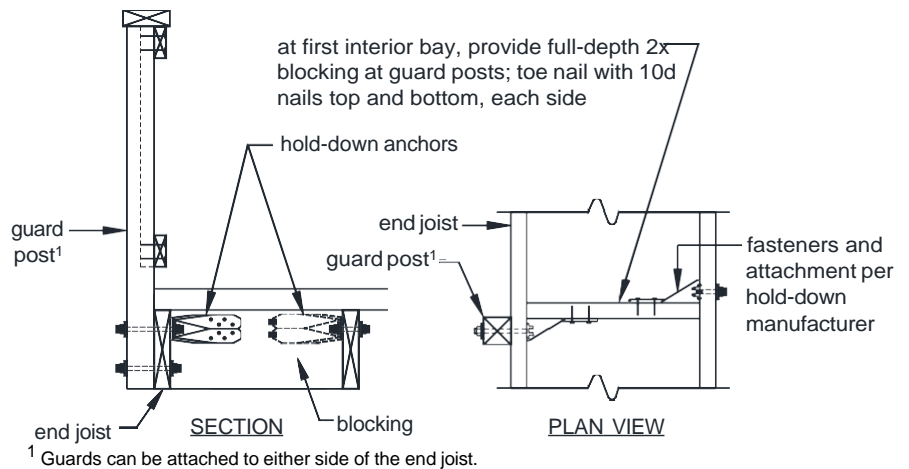

FIGURE 36: GUARD POST-TO-END JOIST

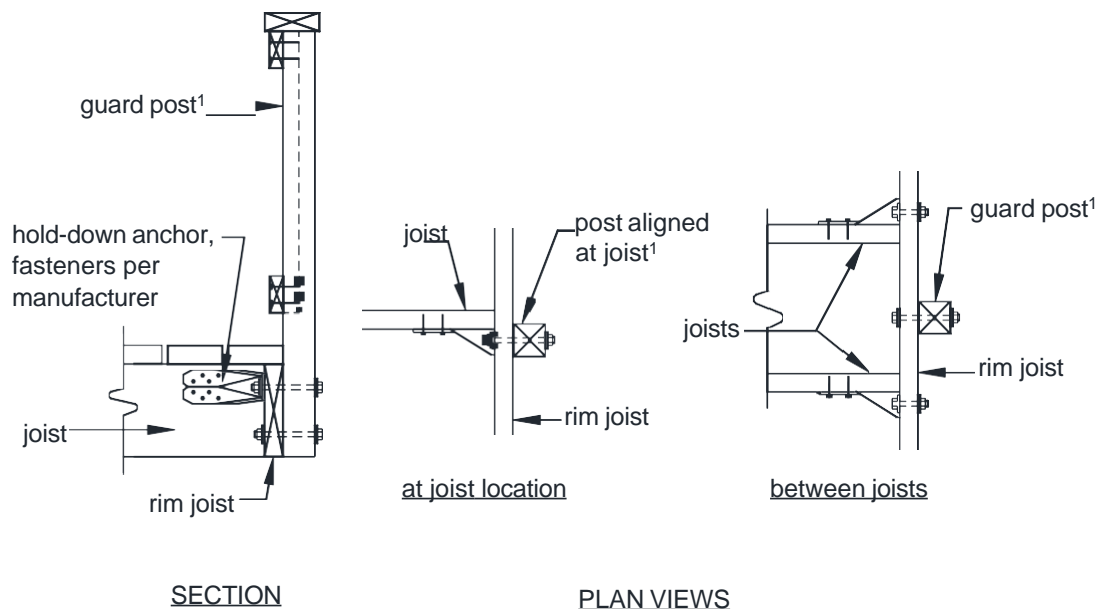

FIGURE 37: GUARD POST-TO-RIM JOIST

9 ■ Stairs

STAIR GEOMETRY: Stairs shall be constructed with the dimensions listed below.

- The minimum width of a stairway is 36 inches.
- Stair geometry and opening limitations shall meet the requirements shown in **FIGURE 38**. Treads, risers and nosing dimensions shall not deviate at each step by more than $\frac{3}{8}$ inches. Note: a nosing is not required if a minimum 11" tread depth is provided.

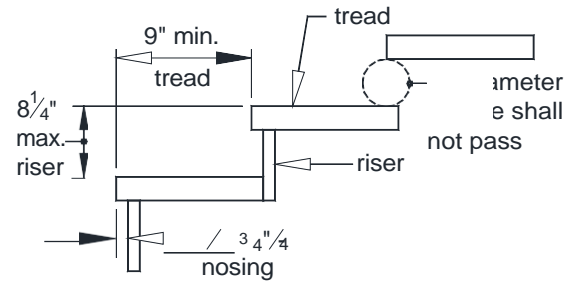

FIGURE 38: TREADS AND RISERS

STAIR LANDING

- If the total vertical height of a stairway exceeds 12 feet, an intermediate landing is required and must be constructed as a free-standing deck.
- Stair landings may be constructed with 4x4 posts with post heights no greater than 8 feet.
- Landing widths shall be equal to the total width(s) of the stairway(s) served.

STAIR CONSTRUCTION: Stair stringers:

- Stringers shall be sawn or solid 2x12s complying with the tread and riser geometry requirements.
- Stringers shall be spaced at a maximum of 18 inches on center.
- ALL Stringers shall bear on footings and attach to the deck or landing.
- Additional approved methods are shown in **FIGURE 39**.
- Stringer span length is measured using the horizontally projected distance between the bearing at each end and shall not exceed the dimensions shown in **FIGURE 40**.
- **SOLID STRINGER EXCEPTION:** Solid stringers of stairways with a width equal to 36 inches shall be permitted to have a span as shown in **FIGURE 40**.
- Throat size of cut stringers shall not exceed the value shown in **FIGURE 40**.

FIGURE 39: STAIR STRINGER ATTACHMENT AND SUPPORT

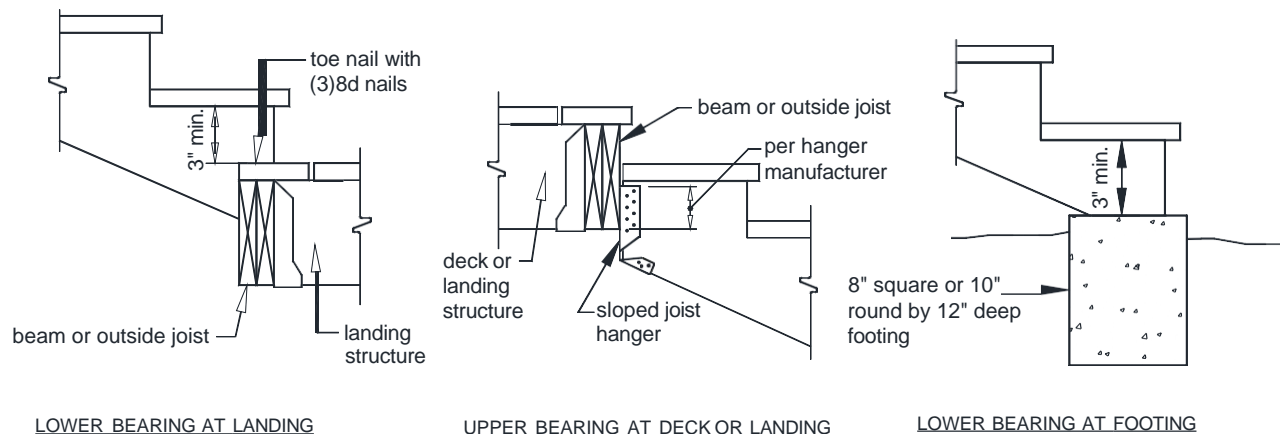

Additional approved methods (FIG.39)

Figure 39: Stair Stringer Connection Detail

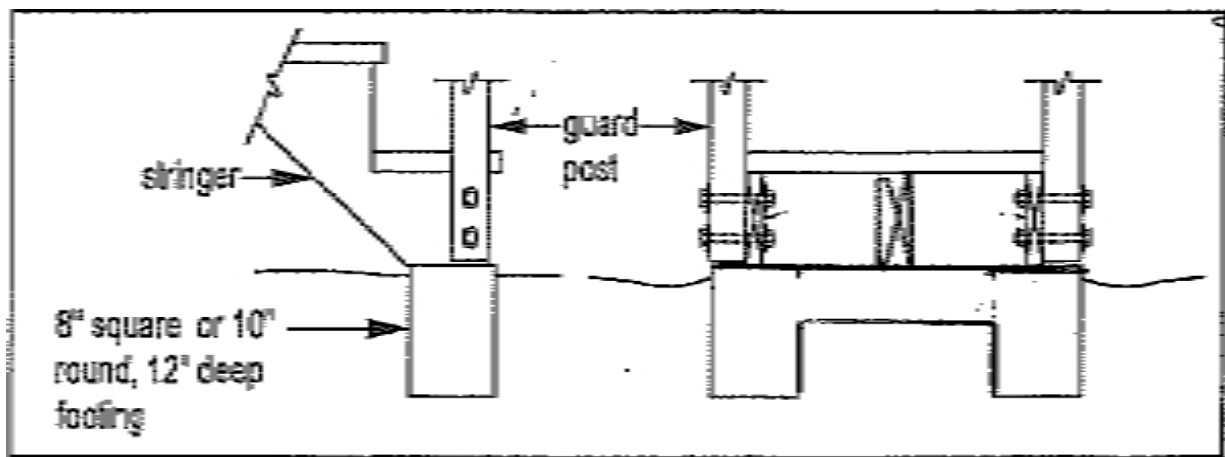

Install blocking and hold-down

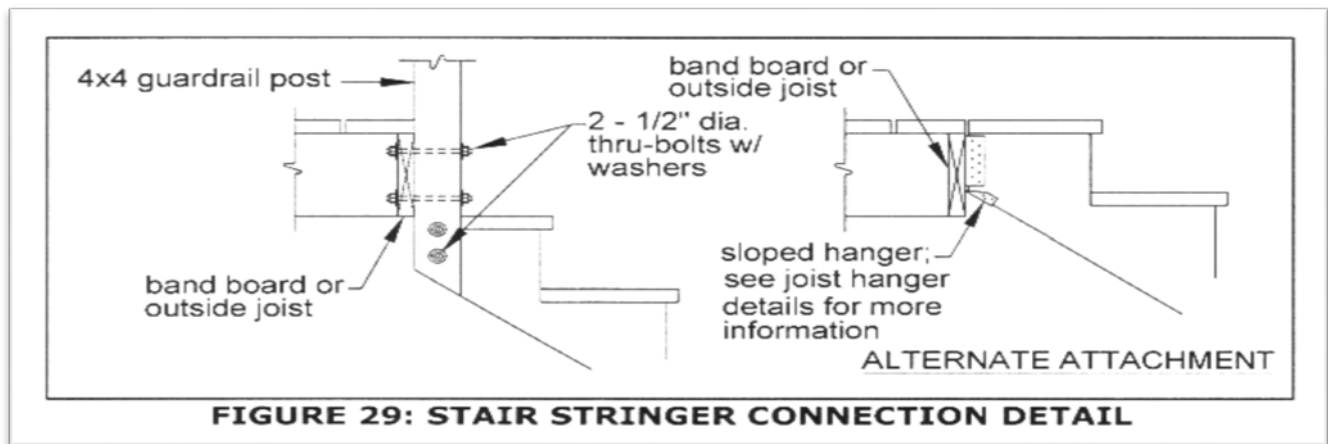
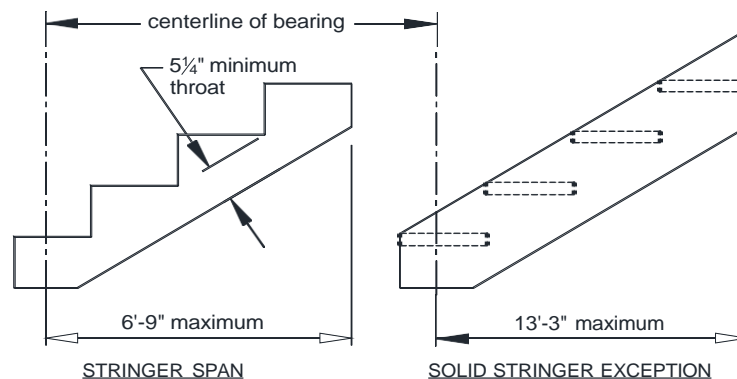

FIGURE 29: STAIR STRINGER CONNECTION DETAIL

Install blocking and hold-down

FIGURE40: STRINGER SPANLENGTH



Tread and riser material:

- Tread material shall be equivalent to the decking specified on Page 4 and attached in accordance with **FIGURE 41**. The span of plastic composites shall be per manufacturer and in some cases may be less than 18 inches specified in **FIGURE 41**.
- Stairs constructed using the solid stringer exception shall have treads constructed of 2x wood material only; see **FIGURE 41**.
- Risers may be framed with 1x lumber minimum or equivalent plastic composite. Open risers are permitted provided the opening does not allow the passage of a 4-inch diameter sphere.

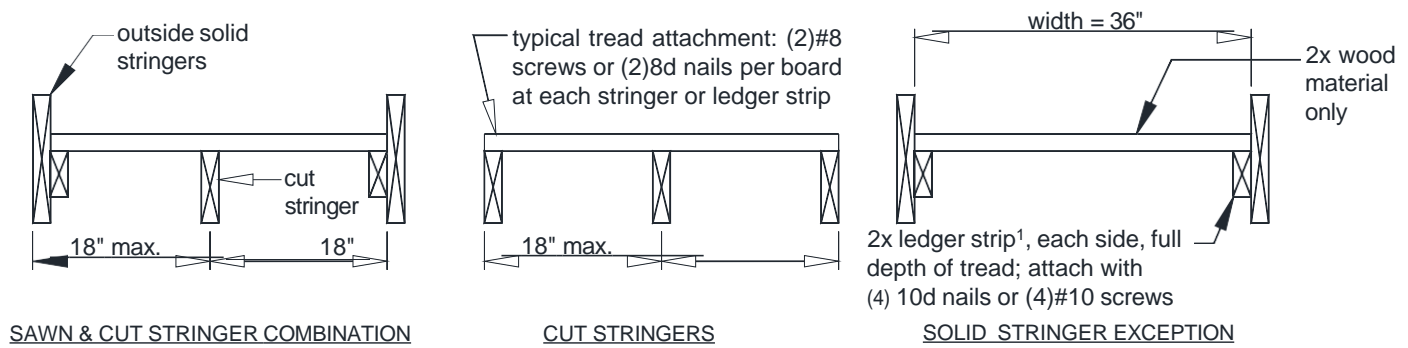

¹ A galvanized staircase clip angle, installed per manufacturer's instructions, is permitted to substitute for the 2x ledger strip.

FIGURE 41: STRINGER TREADS

Stair guards. Stair guards are required when the total rise of the stair is greater than 30 inches at a point 36 inches from the edge of the stair. Stair guards shall be constructed in accordance with Section 8 and **FIGURE 42.**

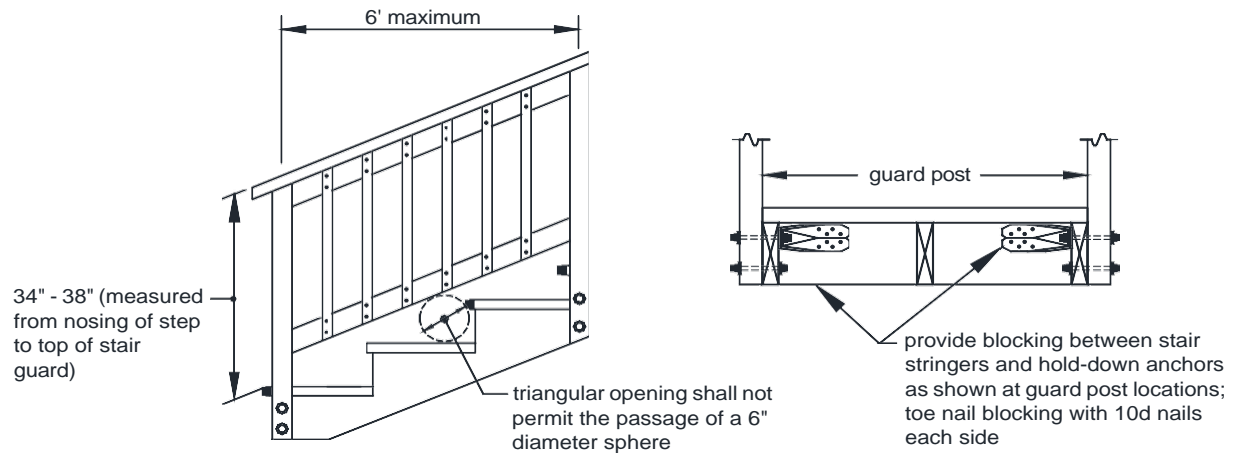

FIGURE 42: STAIR GUARD

Handrails:

- Stairs with four or more risers shall have a handrail on one side at a height between 34 to 38 inches above the nosing of the step.
- Handrails shall be attached to a stair guard or exterior wall acting as a barrier as shown in see **FIGURE 42.**
- Handrail and connecting hardware material shall be decay and corrosion resistant.
- Handrails shall have a smooth surface with no sharp corners and shall be graspable, see **FIGURE 43.** Recessed sections may be shaped from a 2x6 or five-quarter board as shown in **FIGURE 44.**
- Handrails shall run continuously from a point directly over the lowest riser to a point directly over the highest riser and shall return to the guard or wall at each end.
- Handrails may be interrupted by guard posts at a turn in the stair only.
- Handrails installed in lieu of window safety glazing, as required on Page 4, shall be supported at appropriate intervals to ensure that when a 50-pound load is applied, the rail does not deflect into the glass.

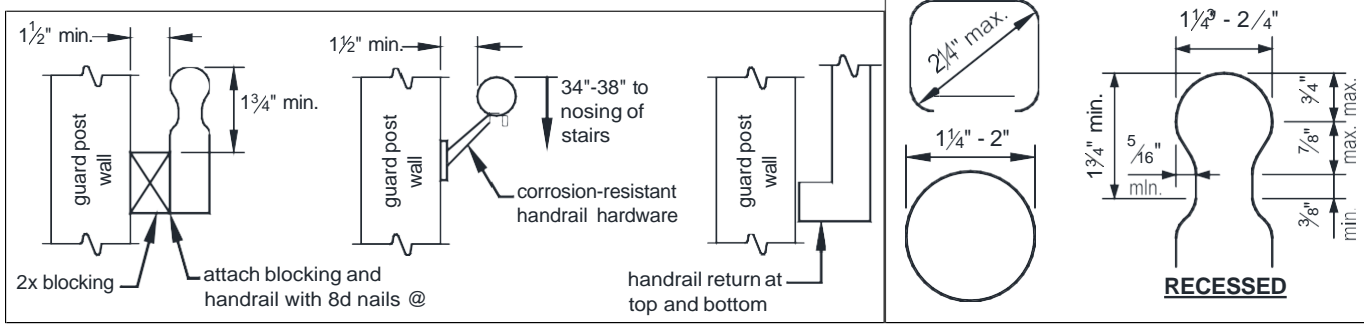
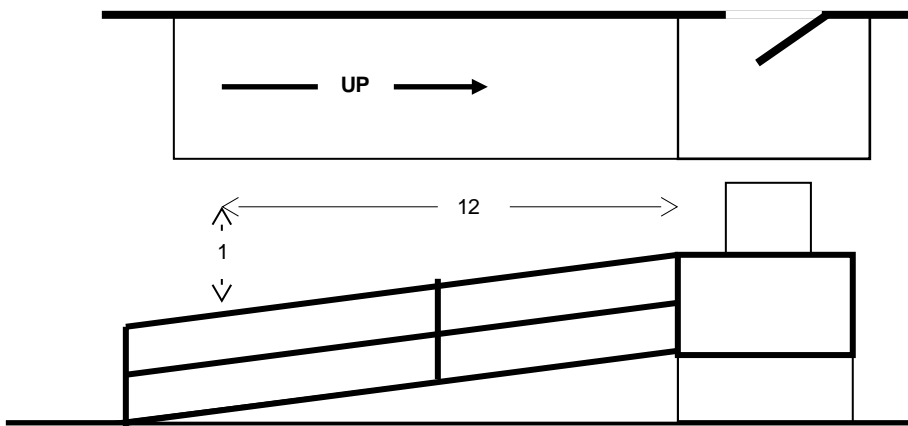

FIGURE 43: HANDRAILS

FIGURE 44: HANDRAIL GRASPABILITY

RESIDENTIAL RAMPS

The maximum slope of a ramp is 1-inch vertical to 12-inches horizontal (8.33 percent slope). Handrails are required on at least one side of all ramps with slopes exceeding a slope of 1-inch vertical in 12-inches horizontal (8.33 percent slope). A minimum 3-foot by 3-foot landing shall be provided, at the top and bottom of ramps, where doors open onto ramps and where ramps change direction. Guardrails are required when the raised floor surfaces are greater than 30 inches above the floor or grade below. (See: **Figure 36: Typical Guardrail Detail**)
A 1:8 Slope Is Allowed Where 1:12 Is Technically Infeasible





King George County

Community Development
10459 Courthouse Dr. King George, Va. 22485

LEDGER ATTACHMENT CERTIFICATION

Must be completed and provided to inspector at footing inspection

Approved 3rd party inspection agencies must submit this completed form to the King George County Community Development office along with there footing inspection report. Ledger

board attachments to existing exterior wall shall be constructed per **FIGURES A-D** and the King George County Typical Deck Details; otherwise a full plan submission is required or the deck must be free-standing. Ledger board fasteners shall be lag screws, thru-bolts, expansion anchors, or approved epoxy anchors. **The material intended to support the deck ledger must be exposed and verified by the inspector at the footing inspection when conditions 1, 2, or 3 are used. (A, 1"-1 1/2" hole must be drilled through manufactured rim boards to verify thickness. A ladder must be provided for the inspection when site conditions warrant one.**

- ☐ CONDITION 1: LEDGER BOARD-TO-BAND BOARD, **A**
- ☐ CONDITION 2: LEDGER BOARD-TO-FOUNDATION WALL (CONCRETE OR SOLID MASONRY), **B**
- ☐ CONDITION 3: LEDGER BOARD-TO-FOUNDATION WALL (HOLLOW MASONRY), **C**
- ☐ CONDITION 4: FREE-STANDING DECK, **D**

CHECK CONDITION THAT APPLIES

I hereby certify that I have adhered to one of the four conditions above, and that the field conditions will match those shown in the King George County Typical Deck Details.

I am the: ☐ Contractor ☐ Owner ☐ Owner's Agent

Print Name _____

Signature _____

Date ____/____/____

A copy of the King George Typical Deck Details and a completed copy of this certification statement are required to be available to the inspector in the field.

Address: _____

Permit Number: _____

FOR COUNTY USE ONLY:

Accepted by: Date: ____/____/____ Inspector: _____